

TOP VIEW EL. -0.10m
AREA DR4

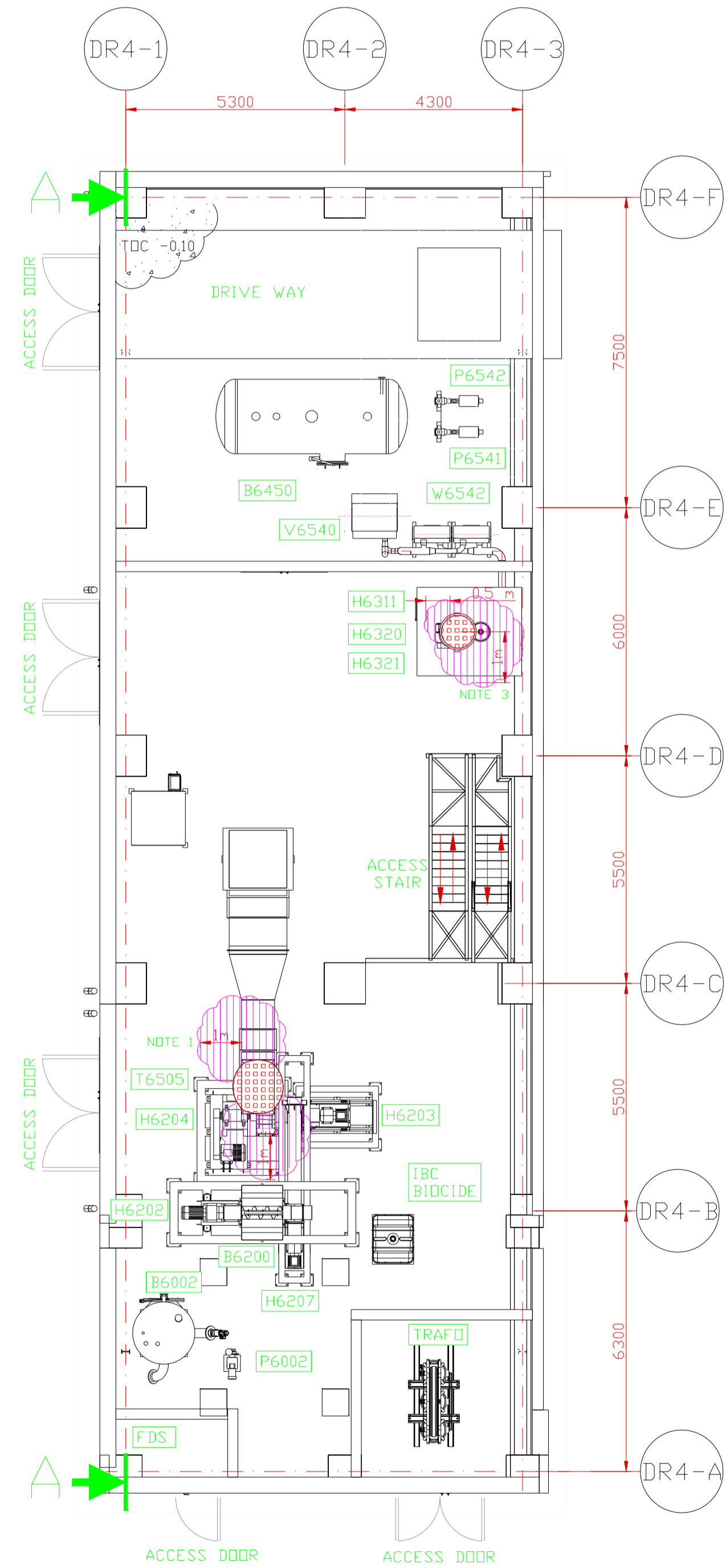

TOP VIEW EL. +5.80m
AREA DR4

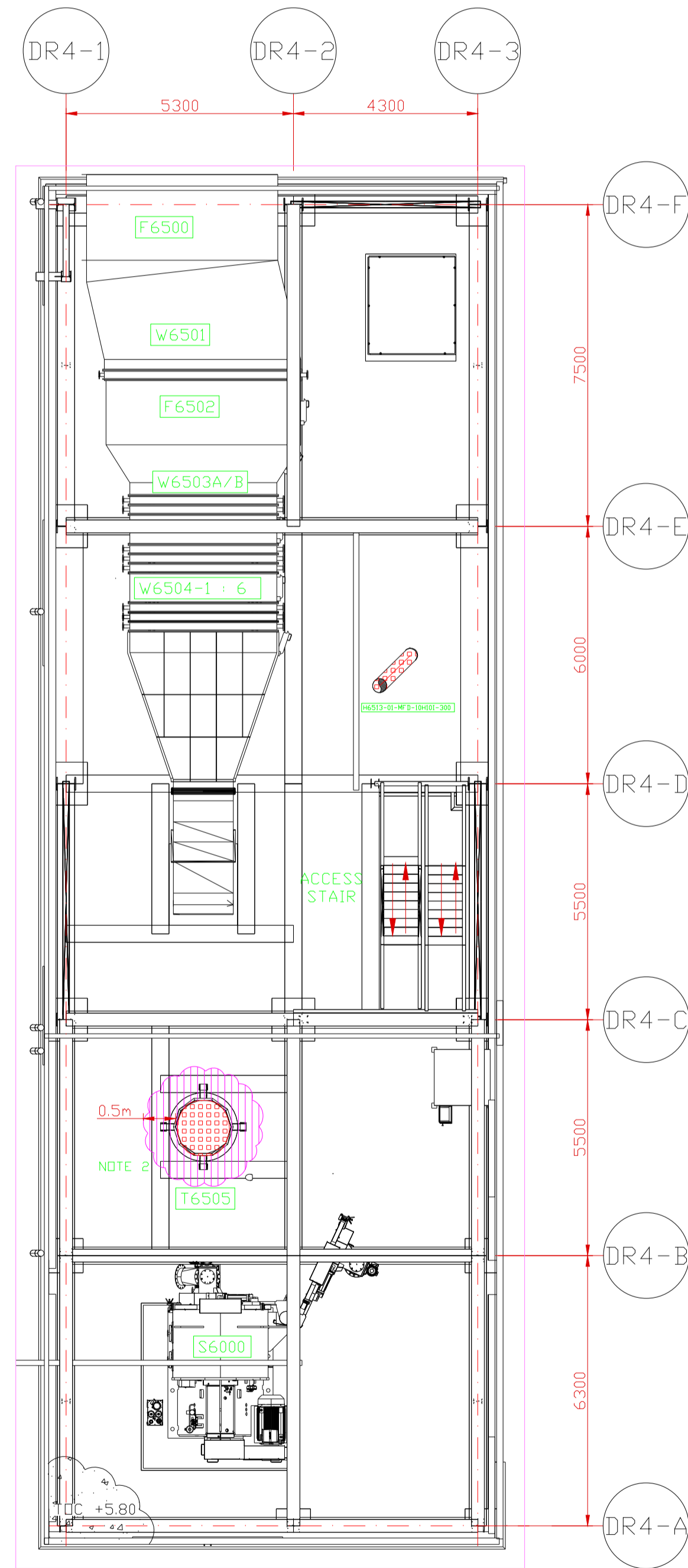

TOP VIEW EL. +11.20m
AREA DR4

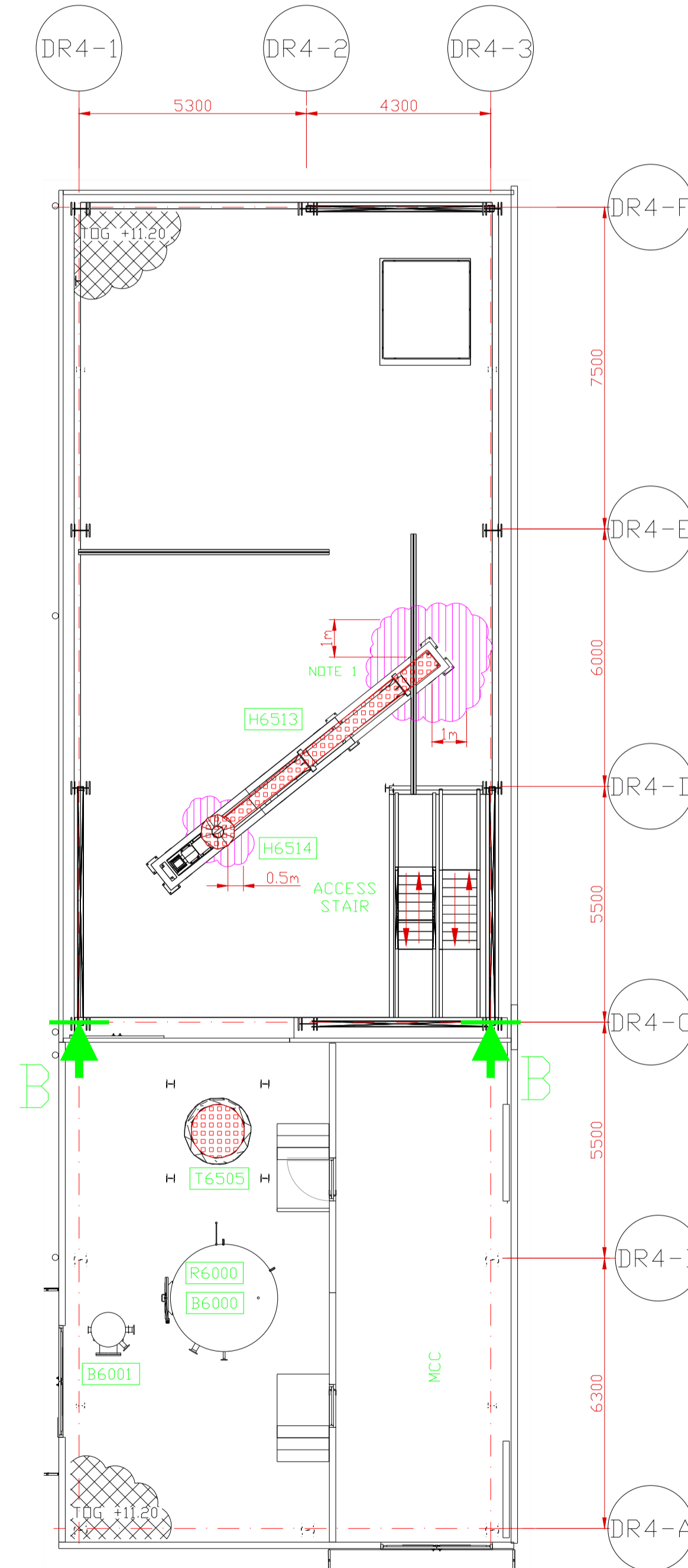

KEY PLAN

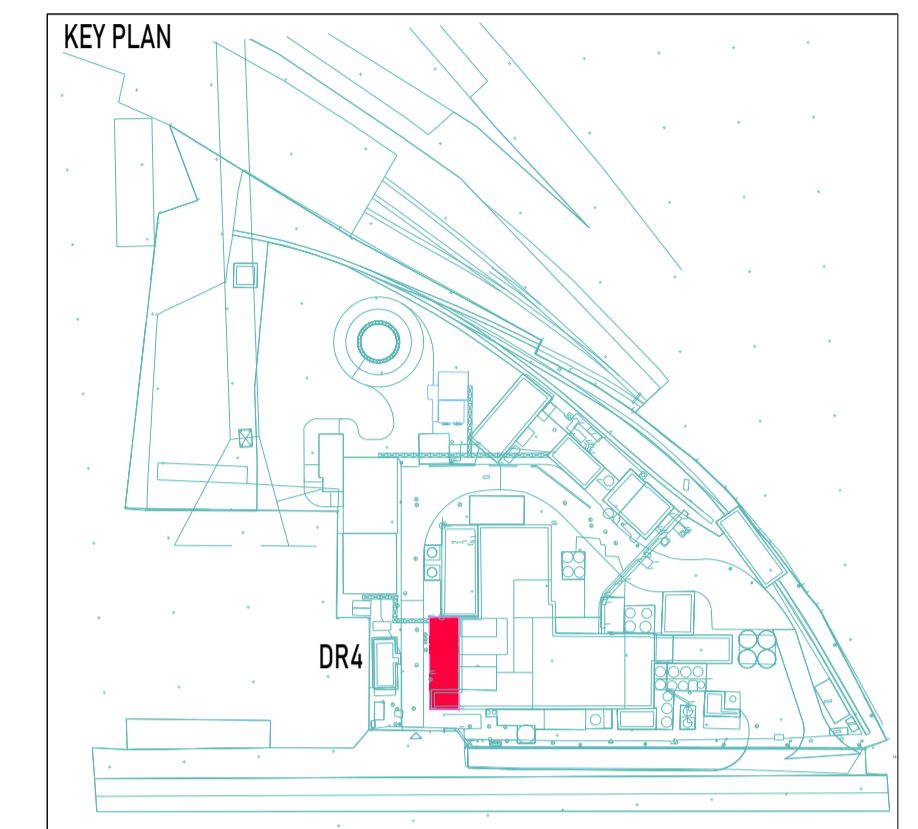
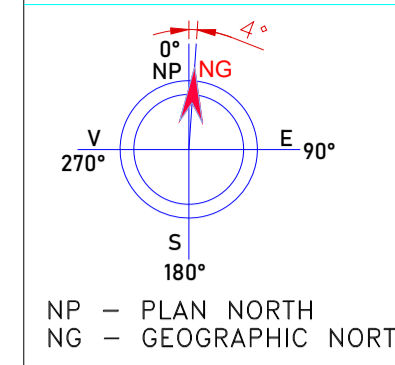

LEGEND

- ZONE 20 - Explosion class IIIBT200°C
- ZONE 21 - Explosion class IIIBT200°C
- ZONE 22 - Explosion class IIIBT200°C

CHARACTERISTICS

1. Characterization of Zones 20/21/22:

Parameter name	Description/Value
Flammable substance	Cornstarch fine dust
Conductive/non-conductive	Non-conductive
Moisture content percentage, %	12
Average particle size, micron	18.6-30.1
Ignition temperature, °C	175
Minimum explosive concentration, g/m3	60
Maximum explosion pressure, barg	8.6
Minimum ignition energy, mJ	300-1000
Glow Temperature, °C	310
Ignition Temperature, °C	420
Deflagration index of a dust cloud, KSt, bar*m/s	144
Explosion group and temperature class	IIIBT200°C

NOTES

1. Manholes assumed according to P&ID.
2. Zone 22 considered around compensator.
3. 1m of Zone 22 considered when changing filter cartridges.
4. Zone 22 on an extraction fan and ducting assuming high efficiency cyclones

GENERAL NOTES

1. ±0.00 LEVEL WAS SET BASED ON THE TOPOGRAPHICAL SURVEY PROVIDED BY THE BENEFICIARY
2. ALL DIMENSIONS ARE IN MILLIMETERS, UNLESS OTHERWISE NOTED
3. THIS DRAWING MUST ALWAYS BE USED IN CONJUNCTION WITH ALL OTHER GENERAL NOTES DRAWINGS, CIVIL DESIGN CRITERIA AND PROJECT SPECIFICATIONS
4. LEVEL ±0.00 (FINISHED FLOOR) CORRESPONDS TO +20.30 (RMN) AND IS THE REFERENCE LEVEL FOR THE SITE.

00 A.Boscornea A.Boscornea A.Papescu L.Marculescu 05.03.2026 First Issue
 Rev. Designed Drawn Checked Approved Date Revision description
 This document contains proprietary information belonging to LUDAN Engineering S.R.L. Its parent and/or affiliated companies and shall be used only for the purpose for which it was supplied. It shall not be copied, reproduced or otherwise used, nor shall such information be furnished in whole or in part to others, except in accordance with the terms of any agreement under which it was supplied or with the prior written consent of LUDAN Engineering S.R.L. and shall be returned upon request.

Ludan Engineering
 Project No.: 2215PJ Beneficiary: AGFD TANDAREI
 Phase: DDE

Project Name: MODERNIZATION OF THE MODIFIED STARCH PRODUCTION PLANT
 Title: HAZARDOUS AREA CLASSIFICATION-DR4
 EL. -0.10 m to 11.20 m
 Drawing No.: 2215PJ-UE135-DR4-001 Sheet: 1/3 Scale: 1:100 Format: A1

KEY PLAN

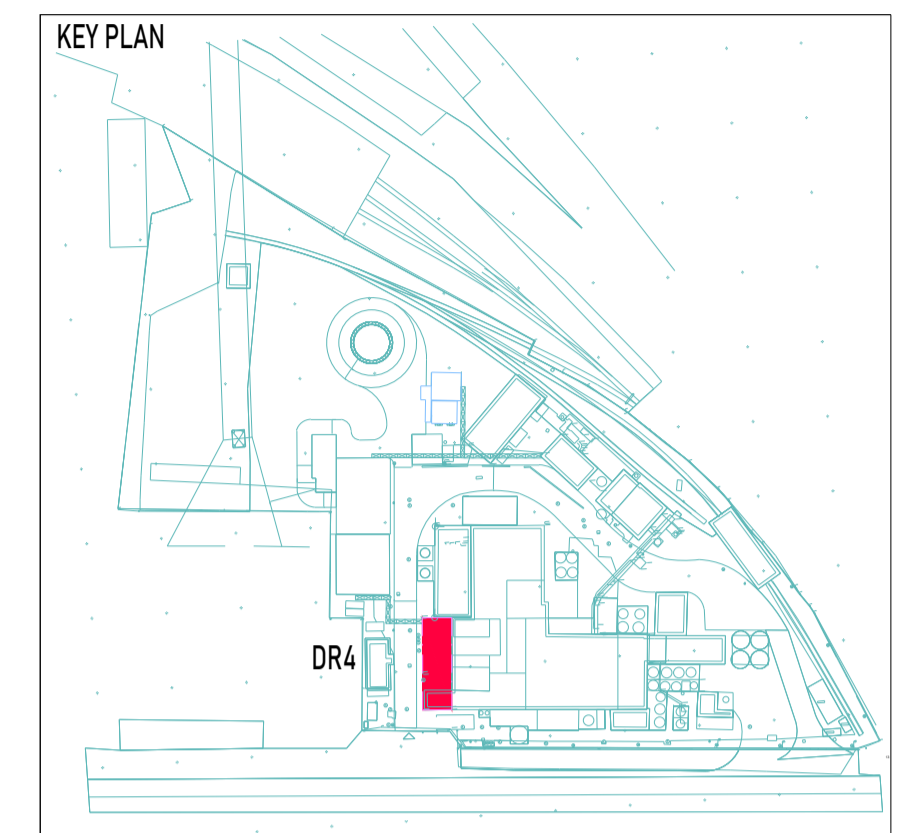
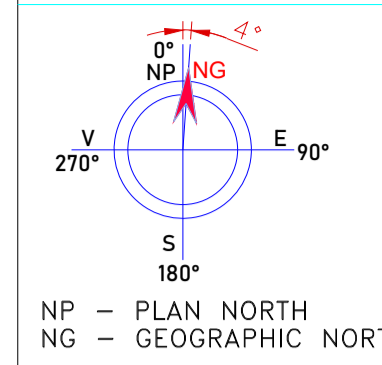

TOP VIEW EL. +14.70m
AREA DR4

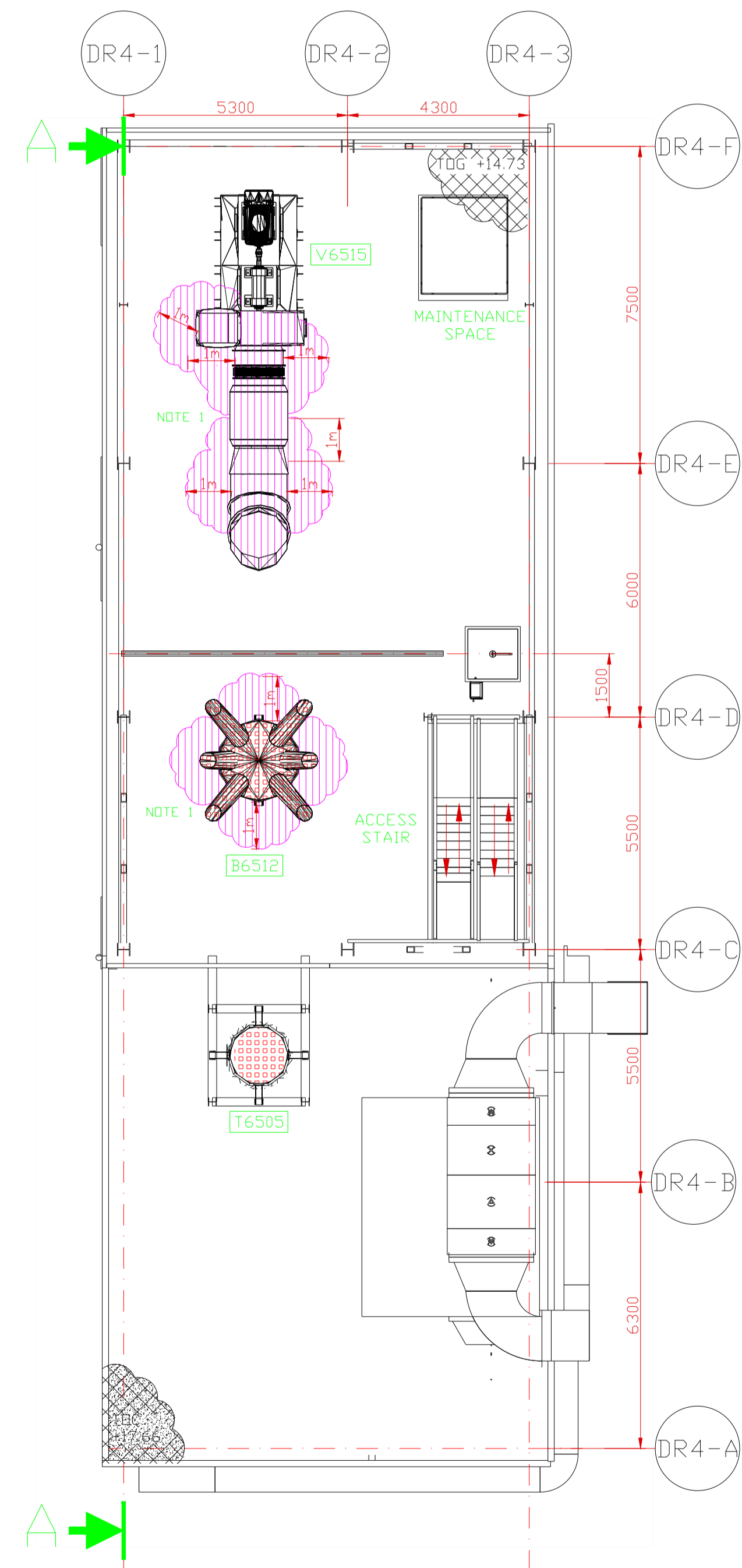

TOP VIEW EL. +19.60m
AREA DR4

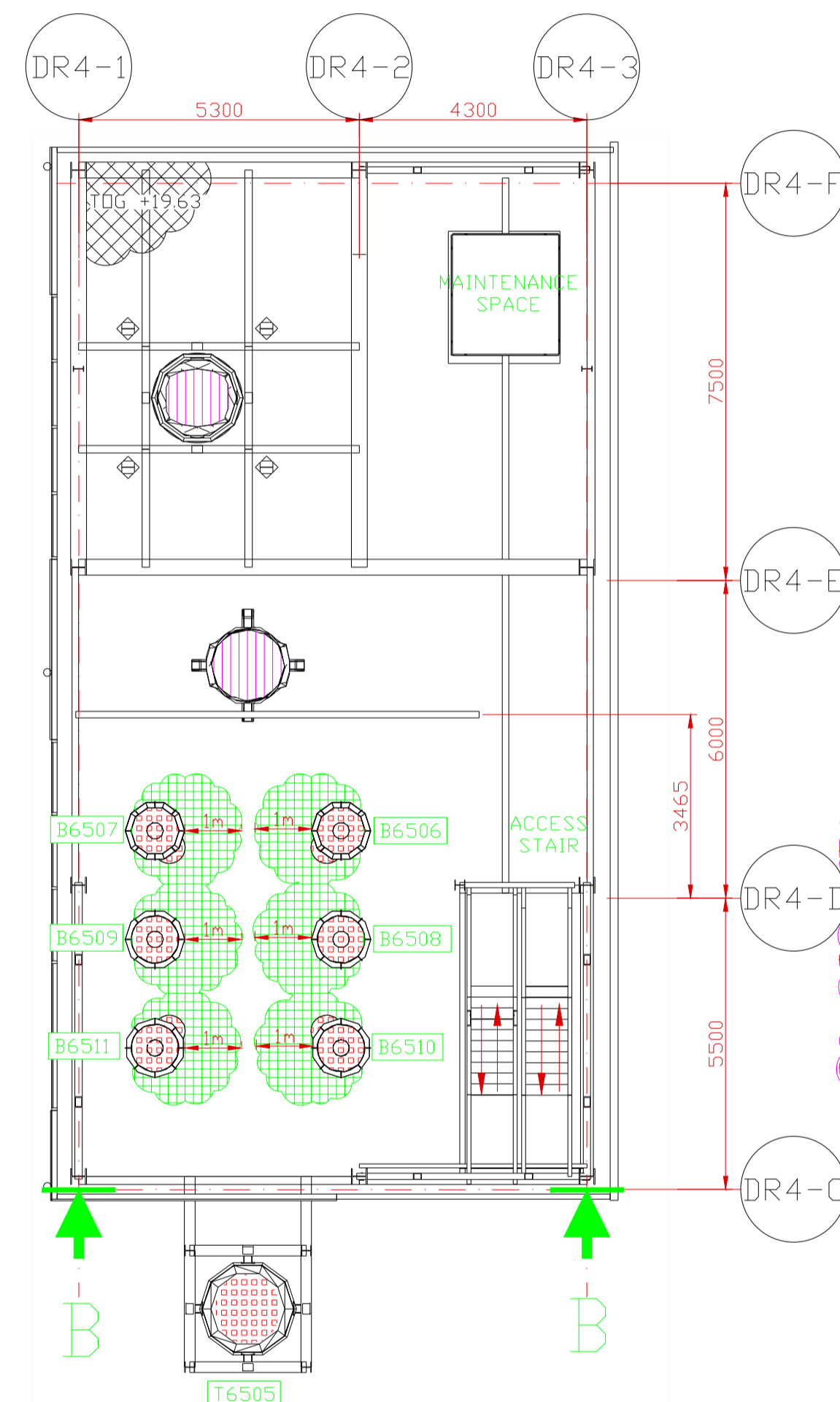

TOP VIEW EL. +25.00m
AREA DR4

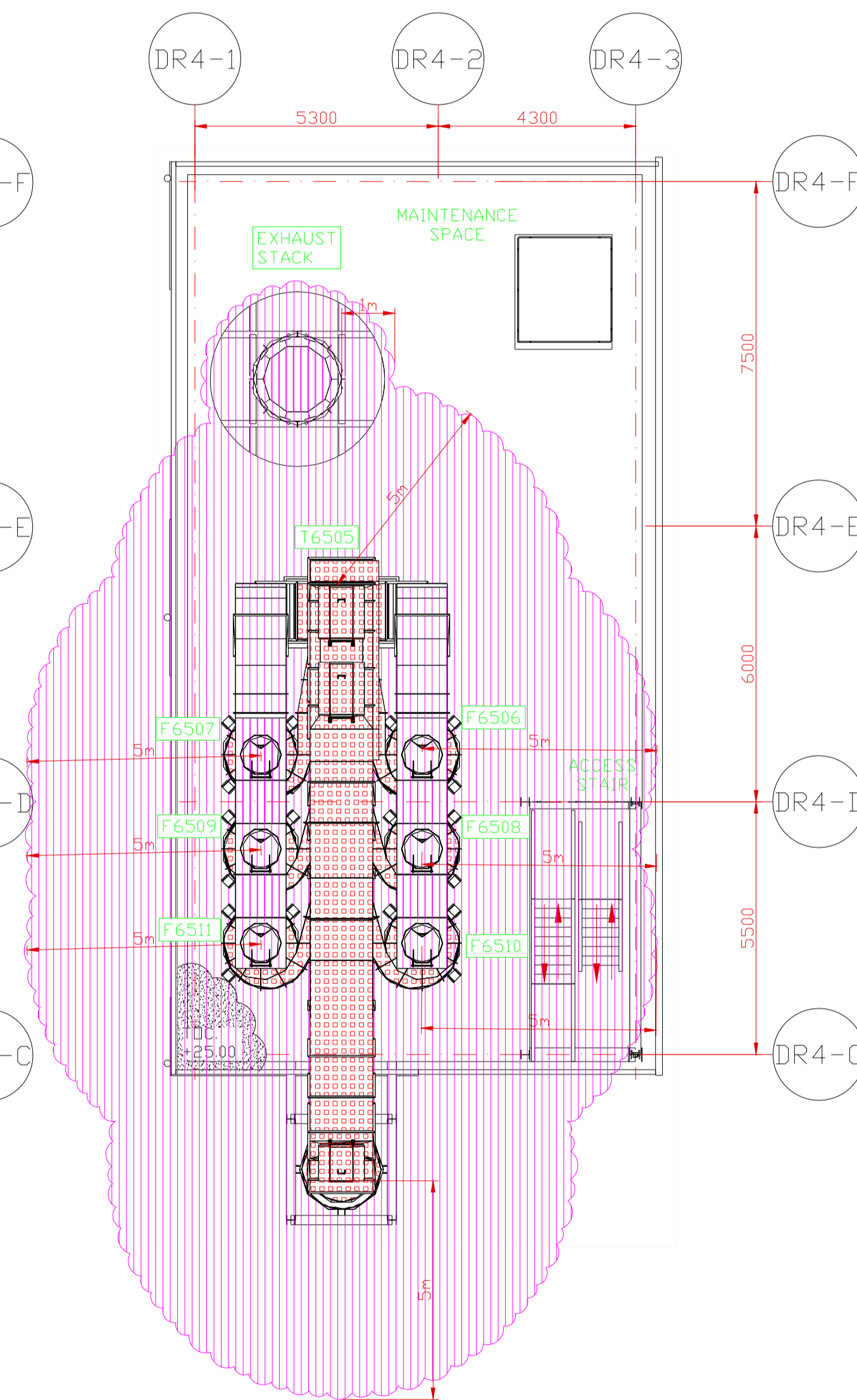

LEGEND

- ZONE 20 - Explosion class IIIBT200°C
- ZONE 21 - Explosion class IIIBT200°C
- ZONE 22 - Explosion class IIIBT200°C

CHARACTERISTICS

1. Characterization of Zones 20/21/22:

Parameter name	Description/Value
Flammable substance	Cornstarch fine dust
Conductive/non-conductive	Non-conductive
Moisture content percentage, %	12
Average particle size, micron	18.6-30.1
Ignition temperature, °C	175
Minimum explosive concentration, g/m3	60
Maximum explosion pressure, barg	8.6
Minimum ignition energy, mJ	300-1000
Glow Temperature, °C	310
Ignition Temperature, °C	420
Deflagration index of a dust cloud, KSt, bar*m/s	144
Explosion group and temperature class	IIIBT200°C

NOTES

1. Manholes assumed according to P&ID.
2. Zone 22 at stack outlet.
3. Zone 22 on extraction fan and ducting assuming high efficiency cyclones

GENERAL NOTES

1. ±0.00 LEVEL WAS SET BASED ON THE TOPOGRAPHICAL SURVEY PROVIDED BY THE BENEFICIARY
2. ALL DIMENSIONS ARE IN MILLIMETERS, UNLESS OTHERWISE NOTED
3. THIS DRAWING MUST ALWAYS BE USED IN CONJUNCTION WITH ALL OTHER GENERAL NOTES DRAWINGS, CIVIL DESIGN CRITERIA AND PROJECT SPECIFICATIONS
4. LEVEL ±0.00 (FINISHED FLOOR) CORRESPONDS TO +20.30 (RMN) AND IS THE REFERENCE LEVEL FOR THE SITE.

0	A.BOSCORNEA	A.BOSCORNEA	A.POPESCU	LMARULESCU	05.03.2026	First Issue
Rev.	Designed	Drawn	Checked	Approved	Date	Revision description

	Project No.: 2215PJ	Beneficiary:
	Phase: DDE	AGFD TANDAREI

Project Name: MODERNIZATION OF THE MODIFIED STARCH PRODUCTION PLANT	
Title:	HAZARDOUS AREA CLASSIFICATION-DR4 EL. +14.73 m to 25.00 m
Drawing No.:	2215PJ-UE135-DR4-001
Sheet:	2/3
Scale:	1:100
Format:	A1

SECTION A-A

SECTION B-B

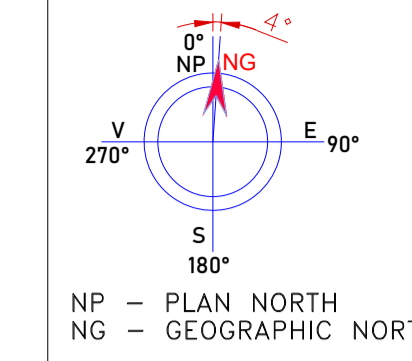

KEY PLAN

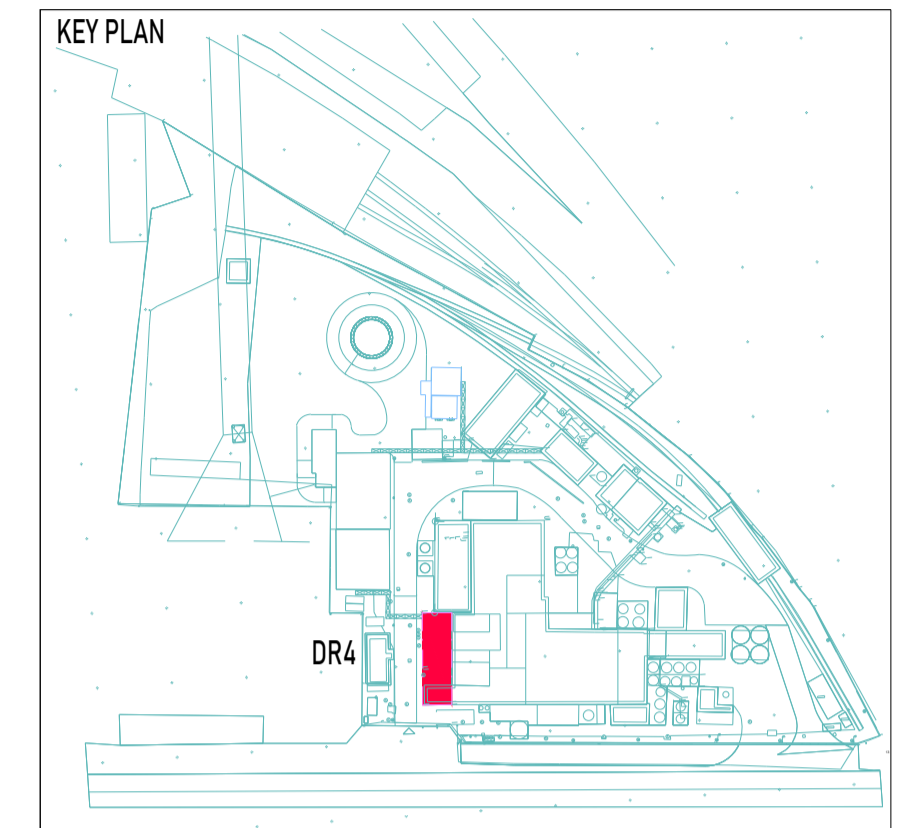

LEGEND

- ZONE 20 - Explosion class IIIBT200°C
- ZONE 21 - Explosion class IIIBT200°C
- ZONE 22 - Explosion class IIIBT200°C

CHARACTERISTICS

1. Characterization of Zones 20/21/22:

Parameter name	Description/Value
Flammable substance	Cornstarch fine dust
Conductive/non-conductive	Non-conductive
Moisture content percentage, %	12
Average particle size, micron	18.6-30.1
Ignition temperature, °C	175
Minimum explosive concentration, g/m3	60
Maximum explosion pressure, barg	8.6
Minimum ignition energy, mJ	300-1000
Glow Temperature, °C	310
Ignition Temperature, °C	420
Deflagration index of a dust cloud, KSt, bar*m/s	144
Explosion group and temperature class	IIIBT200°C

NOTES

1. Manholes assumed according to P&ID.
2. Zone 22 at stack outlet.
3. 1m of Zone 22 considered when changing filter cartridges.
4. Placeholder for rotary valve H6514
5. Zone 22 on extraction fan and ducting assuming high efficiency cyclones

GENERAL NOTES

1. ±0.00 LEVEL WAS SET BASED ON THE TOPOGRAPHICAL SURVEY PROVIDED BY THE BENEFICIARY
2. ALL DIMENSIONS ARE IN MILLIMETERS, UNLESS OTHERWISE NOTED
3. THIS DRAWING MUST ALWAYS BE USED IN CONJUNCTION WITH ALL OTHER GENERAL NOTES DRAWINGS, CIVIL DESIGN CRITERIA AND PROJECT SPECIFICATIONS.
4. LEVEL ±0.00 (FINISHED FLOOR) CORRESPONDS TO +20.30 (RMN) AND IS THE REFERENCE LEVEL FOR THE SITE.

0 A.BOSCORNEA A.BOSCORNEA A.POPESCU L.MARCULESCU 05.03.2026 First Issue Rev. Designed Drawn Checked Approved Date Revision description This document contains proprietary information belonging to LUDAN Engineering S.R.L. Its parent and/or affiliated companies and shall be used only for the purpose for which it was supplied. It shall not be copied, reproduced or otherwise used, nor shall such information be furnished in whole or in part to others, except in accordance with the terms of any agreement under which it was supplied or with the prior written consent of LUDAN Engineering S.R.L. and shall be returned upon request.	
Project No.: 2215PJ Phase: DDE	Beneficiary: AGFD TANDAREI
Project Name: MODERNIZATION OF THE MODIFIED STARCH PRODUCTION PLANT	
Title: HAZARDOUS AREA CLASSIFICATION-DR4 SECTION A-A, SECTION B-B	
Drawing No.: 2215PJ-UE135-DR4-001	
Sheet: 3 / 3 Scale: 1:100 Format: A1	

