

Microtec GA vs New building by client
19.04.2026

Item 1	
	
2D Client	2D Microtec
Top of first ceiling +5.8m	Top of first ceiling +5.9m
<p>Solution: Decrease the height of ceiling by Microtec</p> <p>Affects:</p> <ul style="list-style-type: none"> • “Z” Position of starch cake inlet duct (against dryer duct) • Increased interence between Agitating element’s hopper and Peeler structure 	
<p>Required action: Alex to confirm whether to go with +5.8 or +5.9 and hint Boda and Afradi for correction if necessary</p>	

Microtec GA vs New building by client
19.04.2026

Item 2

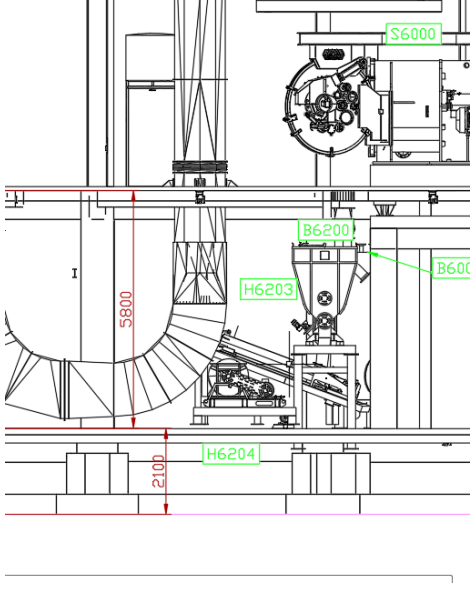
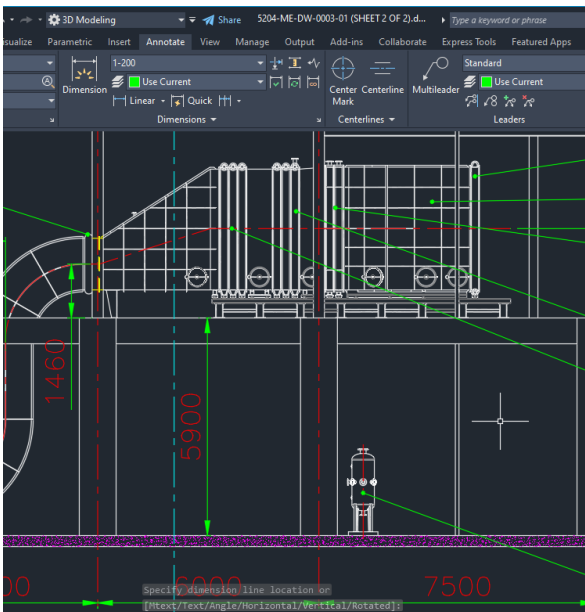
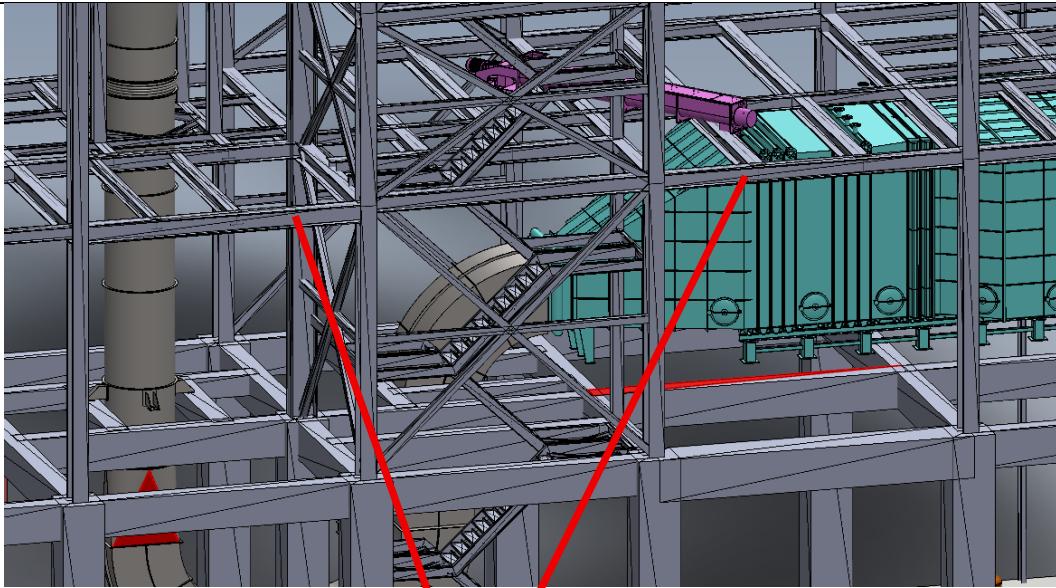

At the second ceiling, floor on the two sides of stair case box are not at the same level, there is 130mm difference (at height)

WE HAVE CONSIDERED THE LEVEL DIFFERENCE BETWEEN CEILING 2 (STEEL) AND CEILING 1 (CONCRETE) IS 5370 mm, THIS IS USED AS A REFERENCE FOR EQUIPMENT SEATS

Required action: Alex to hint to client (For client information)

Item 3

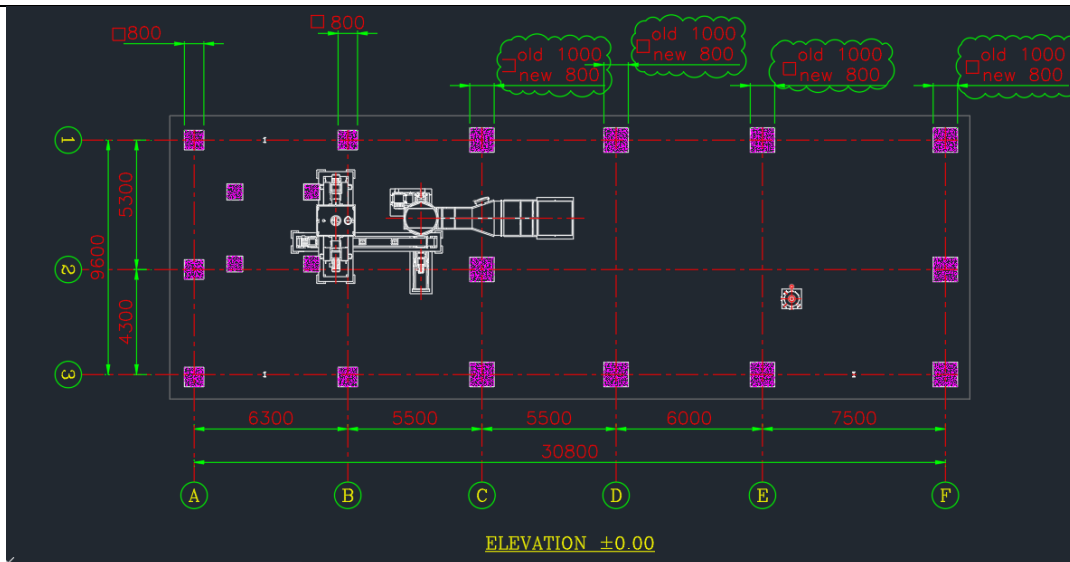

Issue: Columns on (C to F) / (1 to C) is considered 1000x1000, whereas its 800x800 by client

Action to be taken: Columns dimensions to be modified by Microtec

Required action: Alex to clarify with Boda and then hint for modification to Boda and Afradi

Microtec GA vs New building by client
19.04.2026

Item 4

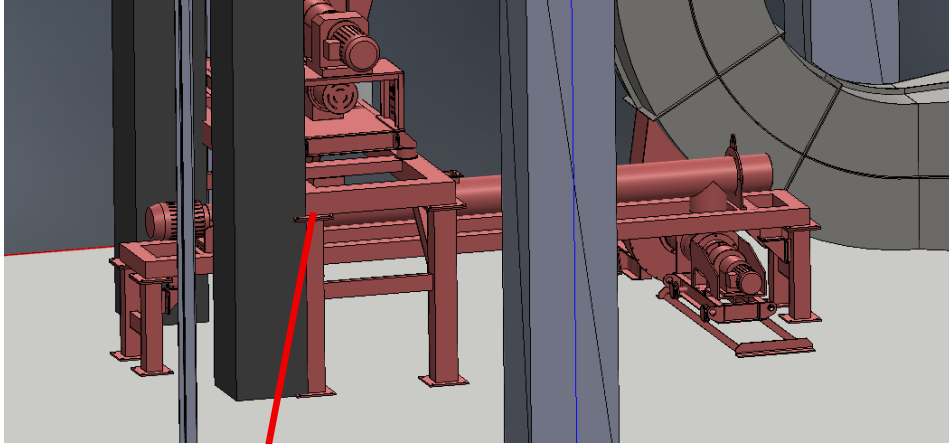

Issue: Agitating feeder base colides with concrete column (of peeler base) around 15cm

Possible modification:

1. Base is too wide, width can be decreased
2. Length of starch cake screw conveyor to be decreased about 12-20 cm

Item 5

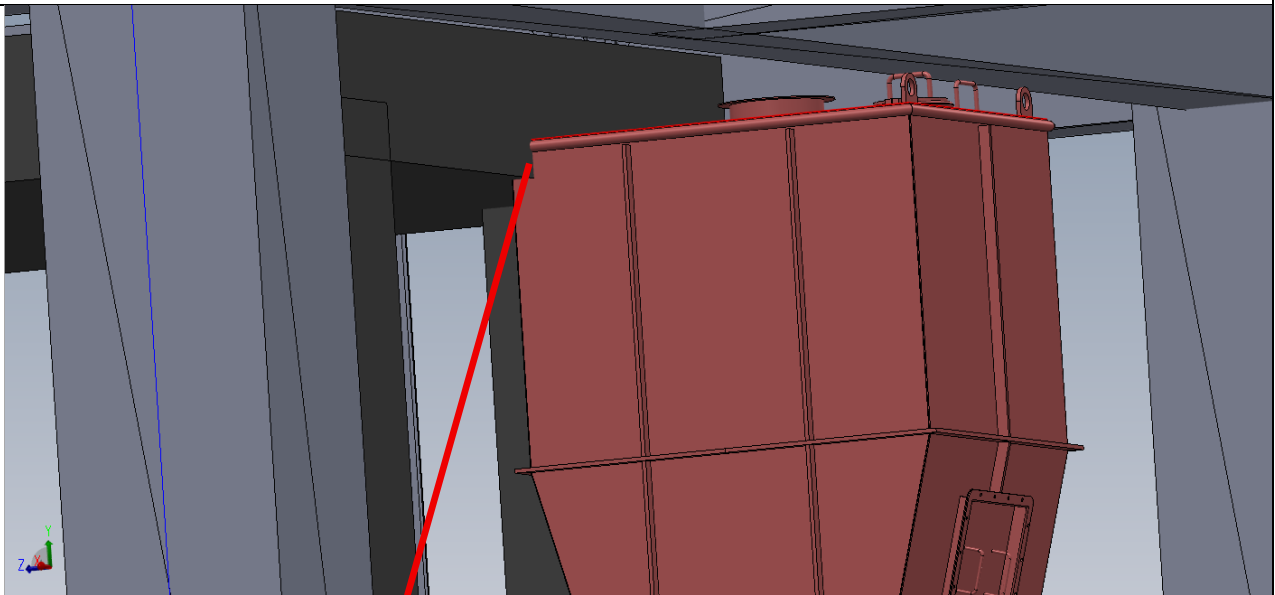

Issue: Agitating element colides with concrete ceiling (of peeler base) around 8cm

Possible modification:

1. Peeler hight to be decreased by aroun 10 cm
2. Length of starch cake screw conveyor to be decreased about 12-20 cm

Microtec GA vs New building by client
19.04.2026

Item 6

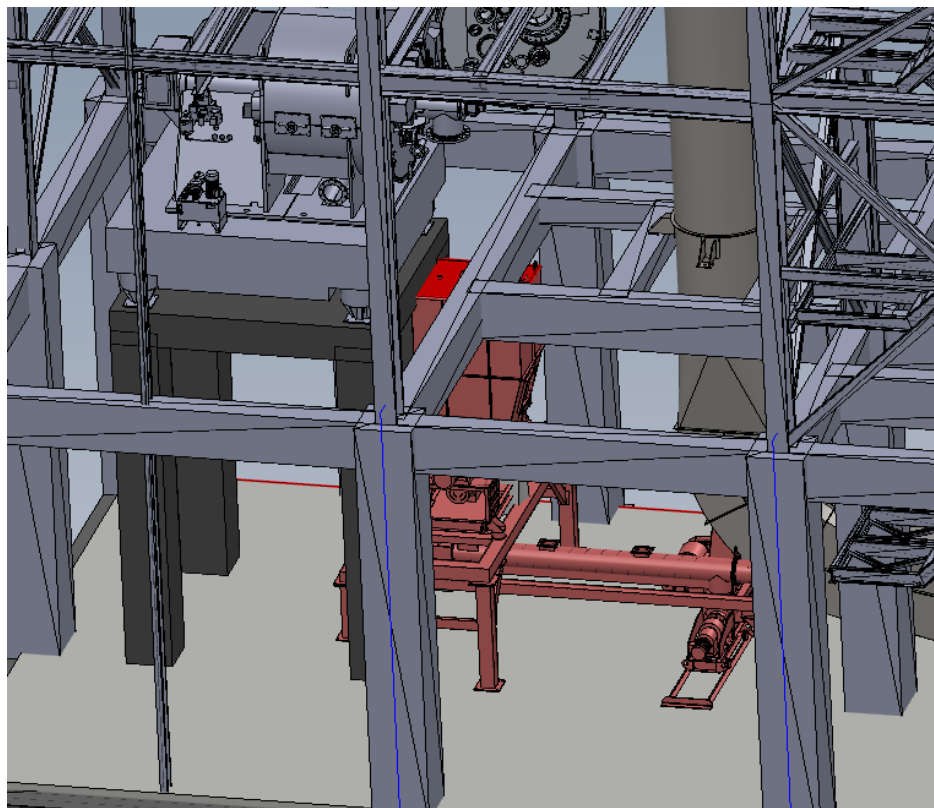
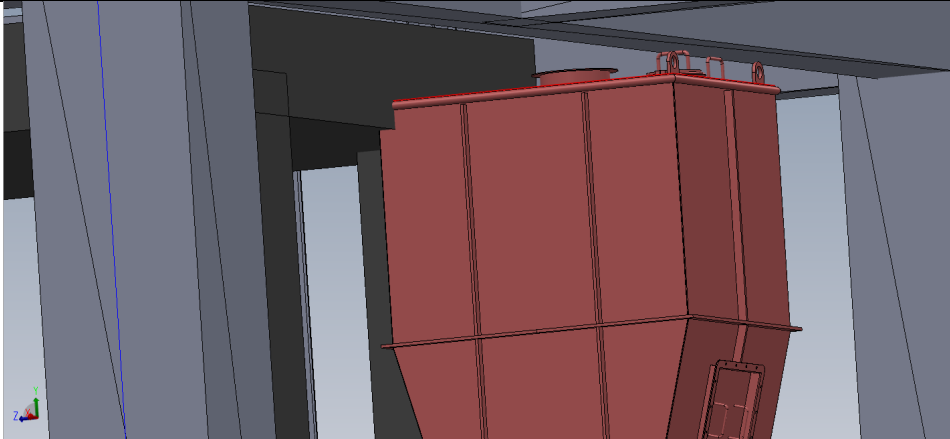

Issue:

1. Peeler outlet port and agitating element inlet port are not coaxial, neither in X nor in Y directions. Specially in Y direction (Y is perpendicular to starch cake screw conveyor axis)
2. Top opening can hardly be opened and removed, even if it could be removed, access to the top of agitating element is almost imposible

Possible modification:

1. Peeler hight to be decreased by around 10 cm
2. Design of concrete ceiling (+5.8) to be modified in order to provide access from top to agitating element's hopper
3. Opening to be brought to the side of the hopper
4. Dry starch screw conveyor length to be decreased

Microtec GA vs New building by client
19.04.2026

Item 6- Continued

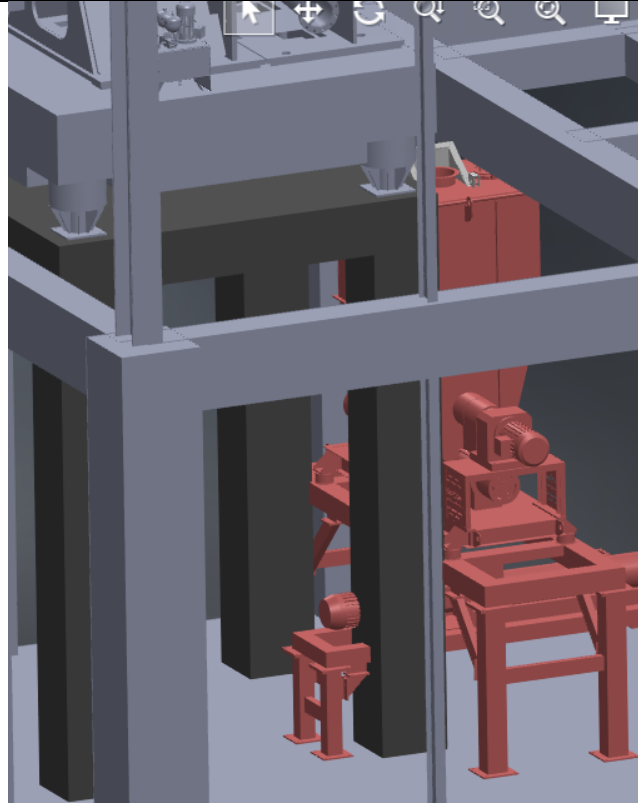

This is what happens when outlet port of peeler and inlet port of agitator be coaxial

Final conclusion: This part of plant better be redesigned in 3D

Required action: Alex to

1. Ask client:
 - a. Whether the position of outlet port of peeler is final, Also the position and all dimenstions of concrete peeler base
 - b. Whether outlet port of peeler and inlet port of agitating element (hopper) should be coaxial
2. Talk with Boda for remedies
3. Advise Boda and Afradi for modifications
4. It seems necessary that the connecting duct between peeler and agitating element be designed and manufactured by Microtec as scope of project

Microtec GA vs New building by client
19.04.2026

Equipments seat levels

EQUIPMENT NAME	SEATS ON LEVEL (m)- By Microtec (After modifying from +5.9 to +5.8)	SEATS ON LEVEL (m)- By Client	Necessary action
Agitating element and feed vessel (B6200 & B6201)	+0.0	+0.0	-
Starch cake screw conveyer (B6202)			
Starch cake feeder (B6203)			
Starch cake blower (B6204)			
Condensate tank (B6515)			
Heater Assy.	+5.8 m	+5.8	-
Dryer duct fixed bracket (#1)	+11.17	+11.7	-
Dryed starch screw conveyer (H6513)	+14.7	+14.7	-
Dryer duct pin guided bracket (#2)			
Dry starch receiving silo (B6512)			
Starch dryer fan (V6515)			
Dryer duct pin guided bracket (#3)			
Fan duct bracket (Lower)	+19.6	+19.6	-
Dryer duct fixed bracket (#4)	+24.84	+25.0	To be clarified
Fan duct bracket (Upper)			
Exhaust duct fixed bracket			
Starch dryer cyclones (F6506 to F6511)			